

## Features

- Solid brass frame
- Basket extends approximately 3-15/16" from the wall
- Basket has a running length of approximately 6-1/8"

## Basket G500

## Codes / Standards Compliance

Meets or exceeds the following at date of manufacture:

- All applicable US Federal and State material regulations



## Colors / Finishes

- PC: Polished Chrome
- PN: Polished Nickel
- SN: Satin Nickel

## Specified Model

Model	Description	Colors   Finishes
G500	Soap Basket	<input type="checkbox"/> PC <input type="checkbox"/> PN <input type="checkbox"/> SN

## Product Specification: Add "Color / Finish" Suffix to Model Number Below

The Basket shall be of solid brass construction. Basket Shelf shall incorporate a projected depth of approximately 3-15/16" from the wall a running length of approximately 6-1/8". Basket shall be Ginger Model G500/\_\_\_\_\_.

# G500

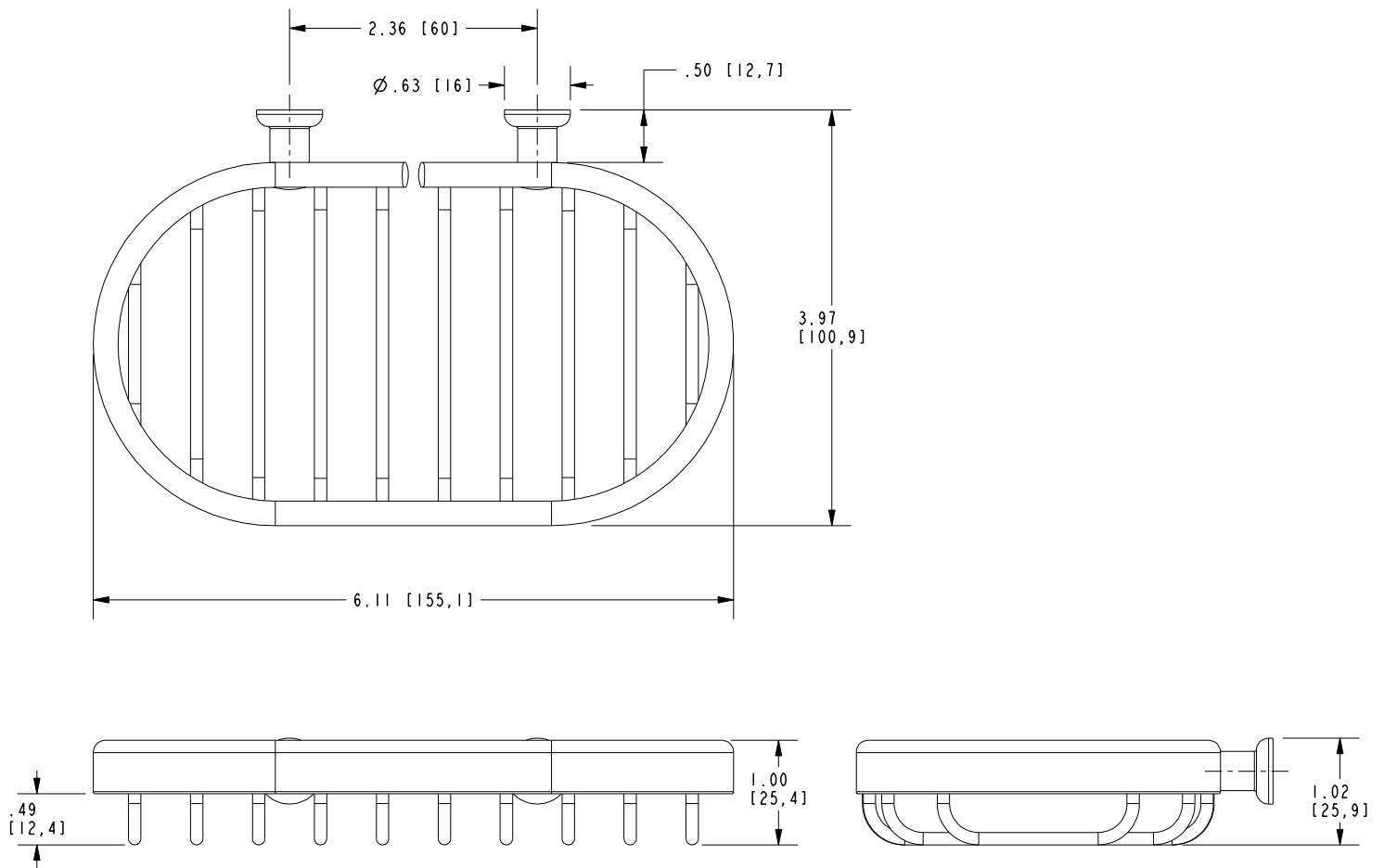

## Splashables Basket G500